

TECHNICAL SPECIFICATION

MODEL	OPENINGS	VOLUME (Ltrs.)	DOME VOLUME (Ltrs.)	DIMENSIONS (mm)					BASE	WEIGHT OF VESSEL WITH BASE (Kg)
				"D1"	"D"	"H" ± 10	"L"	"F"		
21X36	4" TOP	165.6	46.1	540	532	958	40	150	Standard	17.9
21X53	4" TOP	258.0	46.2	540	532	1390	40	150	Standard	23.9
21X62	4" TOP	307.2	46.2	540	532	1620	40	150	Standard	28.2

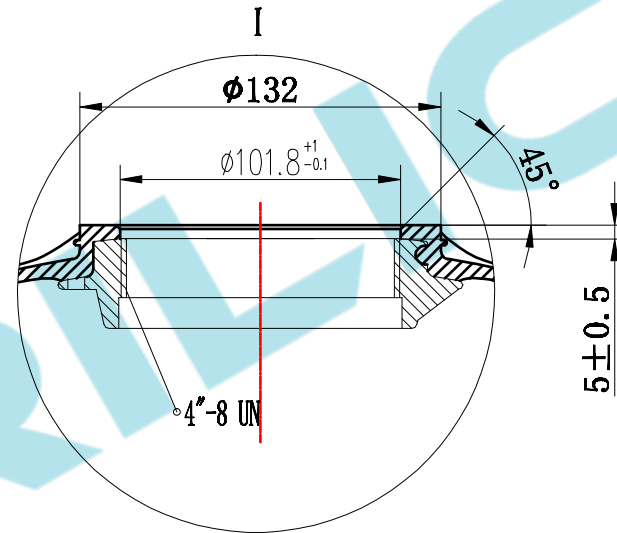

4"-8UN Internal Thread	
PITCH DIA	3.918-3.930"
MINOR DIA	3.865-3.875"
MAJOR DIA	4-4.010"

NOTES:	
1. TANK MUST MEET ALL APPLICABLE SPECIFICATIONS OF NSF/ANSI Q4A STANDARD, LATEST REVISION.	
2. OPERATING SPECIFICATIONS:	
A. MAXIMUM WORKING PRESSURE:	10.50AR (150PSI)
B. TEMPERATURE RANGE:	1-50°C (34-122°F)
C. MAXIMUM VACUUM:	17kpa (5" Hg)

SIGNATURE			SCALE 1: 8	MODEL: 21" (4" TOP)
NAME	DATE			
DESIGN			QUANTITY	DESCRIPTION: FRP PRESSURE VESSEL
INSPECTION				
APPROVAL			COMPUTER CODE	DRAWING NO.
THIS DRAWING CAN NOT BE COPIED AND/OR USED WITHOUT PRIOR WRITTEN APPROVAL OF NOVI				
DO NOT MEASURE THE DIMENSIONS.			NY-TE-DR-SA-IEV-21	1.4
			UNIT: MM [] INCH	TOTAL PAGE: 1 OF 1